

# OLYMPUS®

Your Vision, Our Future

Microscope Digital Camera

# DP73

**NEW**

## A Multi-talented Digital Camera with Latest Technologies



Unparalleled 17.3 Megapixel Resolution: New 3-CCD Mode Enables Pixel Shifting of 3 Colors

Live, High-definition Images at 15 Frames per Second, without Compression

WiDER Optimizes Contrast and Brightness in Individual Image Regions

OLYMPUS Stream Software: A New Standard for Workflow Flexibility

## DP73 specifications

Item	Specifications
Camera type	Single chip color CCD (pixel shifting) Cooling system: Peltier device (max. Ta -10 °C)
Imaging Sensor	Size: 1/1.8 inch 2.01 megapixels color CCD
	Scanning mode: Progressive
Camera mount	C-mount
Effective image resolution	4800 x 3600 (pixel shifting, 3-CCD mode) 2400 x 4800 (pixel shifting, 3-CCD mode) 1600 x 1200 (1 x 1, 3-CCD mode) 800 x 600 (1 x 1) 800 x 600 (2 x 2) ROI
Sensitivity	ISO 100/200/400/800/1600
A/D	14 bit (effective pixel : 12 bit@16 bit mode image)
Metering modes	Mode: Auto, SFL-Auto, Manual
	Adjustment: ±2.0 EV step: 1/3 EV
	Time: 23 μs to 60 s
Metering modes	Full image, 30%, 1%, 0.1%
Binning	2 x 2
Live frame rate*	1600 x 1200 (1 x 1): 15 fps
	800 x 600 (1 x 1): 15 fps
	800 x 600 (2 x 2): 27 fps
Still image transfer time*	4800 x 3600 (1 x 1): approx. 4 s
Color space	sRGB, AdobeRGB
Image file format	File formats supported by OLYMPUS Stream
OS	Windows 7 Professional/Ultimate (64 bit)
Dimensions, weight	Camera interface cable: Approx. 2.8 m/approx. 0.23 kg
	External trigger cable: Approx. 0.2 m/approx. 40 g

\* For exposure times ranging from 23 μs to 65 ms, image acquisition time may take longer if several tasks are active in the background.  
 \* Replacement parts are available for 5 years after purchase.

## DP73 system requirements

	PC/AT compatible
CPU	Intel Core series 1.8 GHz or later (Core2 Duo E6400 2.13 GHz or later recommended)
RAM	4 GB or more
HDD	Free space of 1 GB or larger (at the time of installation)
Graphic	VGA card for PCI-Express x16 with display of 1280 x 1024 or better, 32-bit color per pixel Onboard graphic also available
Extension slot	PCI-Express x1 Rev. 1.0a or later Compatible with half size or LowProfile PCIe board (106.7 mm x 174.6 mm)
OS	Windows 7 Professional/Ultimate (64 bit)
Power supply	250 W or more (with CE marking) Unoccupied FDD power cable, HDD power cable (4-pin size), or Serial ATA power cable must be available

## DP73 system diagram

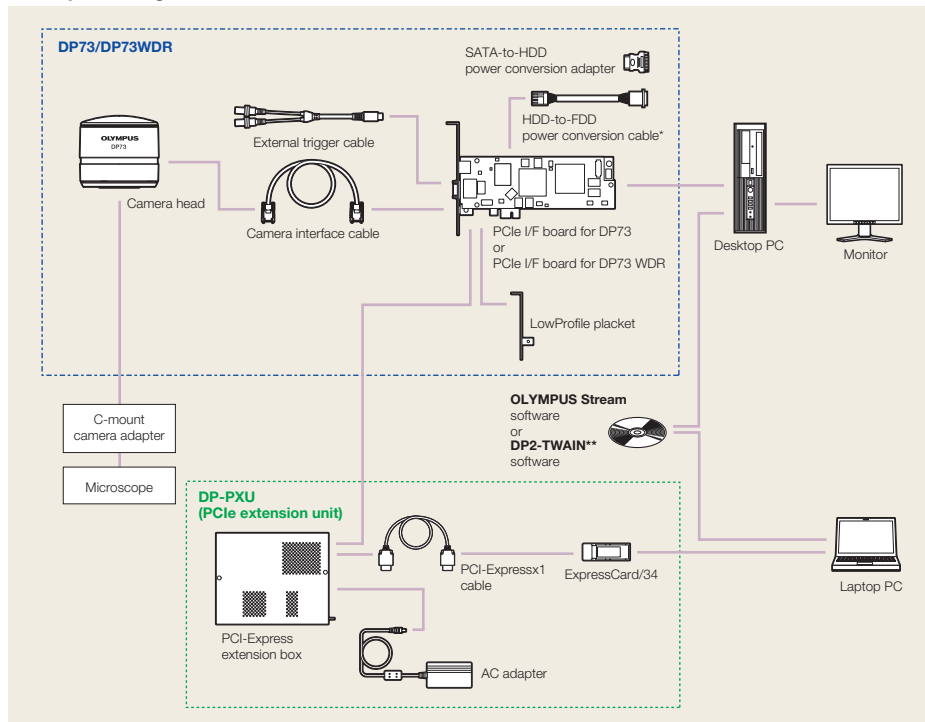

\* Not used when the DP-PXU is combined \*\* Download from our web site required

## DP73 camera head dimensions

(unit: mm)

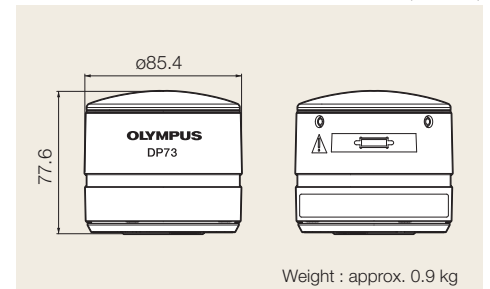

## ECO-PRODUCTS

DP73 is the environmental conscious product according to OLYMPUS' own standards.

- OLYMPUS CORPORATION is ISO14001 certified.
- OLYMPUS CORPORATION is FM553994/ISO9001 certified.

- Windows is either registered trademark or trademark of Microsoft Corporation in the United States and/or other countries. All other company and product names are registered trademarks and/or trademarks of their respective owners.
- Images on the PC monitors are simulated.
- Specifications and appearances are subject to change without any notice or obligation on the part of the manufacturer.

**OLYMPUS**

**OLYMPUS CORPORATION**  
Shinjuku Monolith, 3-1 Nishi-Shinjuku 2-chome, Shinjuku-ku, Tokyo, Japan  
**OLYMPUS (CHINA) CO., LTD.**  
11F, K. Wah Centre, 1010 Huailhai Rd(M), Xuhui District, Shanghai, P.R.C.  
**OLYMPUS KOREA CO., LTD.**  
Olympus-Tower, 114-9 Samseong-Dong, Gangnam-Gu, Seoul, Korea  
**OLYMPUS SINGAPORE PTE LTD.**  
491B River Valley Road, #12-01/04 Valley Point Office Tower, Singapore  
**OLYMPUS AUSTRALIA PTY, LTD.**  
31 Gilby Road, Mt. Waverley, VIC 3149, Melbourne, Australia

www.olympus-ims.com